



HOME SERIES

Aeroponics Hydroponics Herbs System

Instruction Manual





PACKING LIST



(1) Hydroponic Herbs System



(1) Telescopic Rod



(12) 2" Grow Domes



(12) 2" Net Pots



(1) Power Adapter



ASSEMBLY

Step 1

Screw the telescopic rod into the light board.

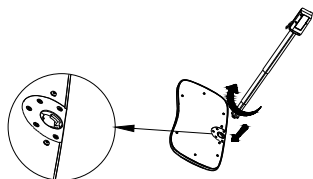

Step 2

Insert the telescopic rod with the connected light board into the tank.

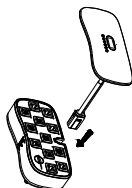

Step 3

Pour the water and plant food into the tank. Ensure that the application rate by the plant food manufacturer is followed.

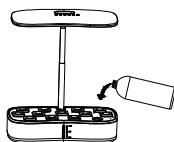

Water & Plant Food

Step 4

Put the seedling cube into the net pot. Then, put the net pot into a growing slot in the tank lid.

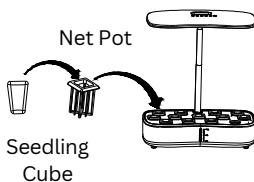

Net Pot

Seedling
Cube

Step 5

Connect the power adapter.



Power Outlet



LIGHT HEIGHT ADJUSTMENT



Push up to raise the light hood.



Push down to lower the light hood.

TIP: When planting, please ensure that the height of the light is adjusted according to the plant's requirements.

Step 1. Add Water Into The Tank

Remove the rubber seal at the bottom-right of the water tank lid and pour the well-mixed plant food solution into the tank.

TIP: Please note the "MAX" line under the rubber seal. The water level in the tank should not exceed the MAX line.

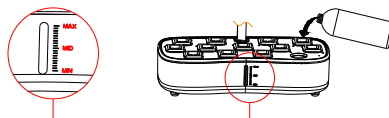

Step 2. Plant Pods

Insert the plant pods into the net pot. Put your seed into the plant pods. Next, place the plant pods into the planting slot in the tank lid. Once complete, turn on the power.

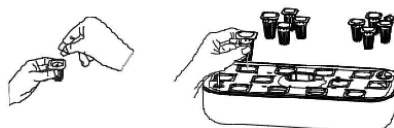

TIP: For better germination rates, please soak the seed for one hour before putting it into the plant pod. Please make sure that the seed is placed inside the plant pod not on the surface of the pod.

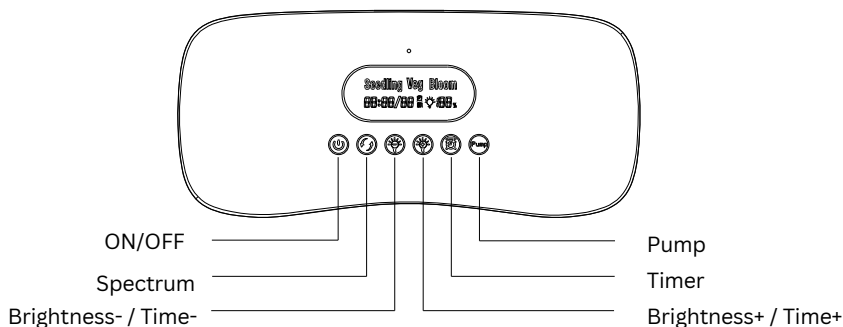

Step 3. Control Functions

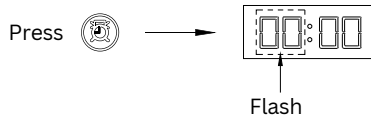

Step 4. Setting The Time

First, press the button below for 5 seconds to start the settings.



Next, press  /  button to adjust the hour.

Next, press  button to confirm.



PLANTING TIPS

1. Choose high-quality seed. The quality of the seed determines whether the seeds can germinate and grow. The success of a garden depends on it.
2. Ensure that the seeds are correctly put into the planting pods and soaked for one hour.
3. Ensure that you follow the dosage recommendations from the plant food manufacturer. Adding too much or too little will cause undesirable results.
4. Do not reuse planting pods.
5. Generally, it is recommended to give the plants 8-12 hours of light per day. Do not allow the lights to be on for 24 hours per day.



FREQUENTLY ASKED QUESTIONS

Frequently Asked Questions

Why do only a few of the plants grow and once sprouted, they quickly wither?

The seeds you purchase make a difference. For best results, purchase seeds from a reliable source and avoid purchasing seeds that are not suitable for hydroponic devices. Ensure you are using the proper nutrients and ratios for those nutrients.

Can planting pods be reused?

We do not recommend reusing planting pods. Doing so, increasing the chance of disease, pests, and more. Additionally, planting pods always work best the first time as their structure is new and not compromised.

Does it kill the plant to remove it from the sponge?

Normally, it doesn't however great care should be taken to ensure the roots are not torn in the process. The plant should be well established before attempting this.

Why is the LED light not turning on?

Please confirm that the product is installed and powered on according to the instructions. If the problem persists, please reach out to your local dealer.

How to clean the water pump?

First, turn the power off. Next, remove the extendable rod and the top cover of the water tank. After the cover is off, take out the sponge in front of the water pump and rinse it with just water. Any cleaning solution will affect the pH balance. If it is very dirty, please rinse the water pump altogether. Lastly, re-install the parts and turn the power on.



WARRANTY

Rest assured, our company provides you with high quality warranty service!

1 Year Manufacturer Warranty. The warranty covers all parts but does not include labor or repair costs. Please reach out to the dealer you purchased this unit from for any warranty claims.

Grower's Authority reserves the right to accept or deny any manufacturer warranty claims at their sole discretion for any or no reason. Some examples of denial reasons include improper use such as incorrect power source, water damage, etc.

Warning



1. Do not put the equipment near any fire source.
2. Do not soak the equipment in water.
3. After the power is turned on, do not touch the surface of the LED lamp body.
4. Do not allow the equipment to be under constant vibration.
5. Do not disassemble the equipment.

This product was distributed by Garden Dominion Supply (GDS) located at 18113 Maugans Ave Hagerstown, MD 21740 United States. You can reach us at (240) 347-7072.

Grower's Authority® is a registered trademark of Garden Dominion Supply® (GDS).